

FLEXIGRIP TILE ADHESIVE

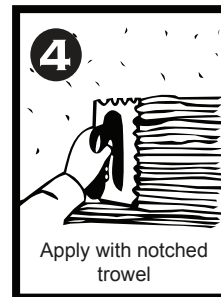
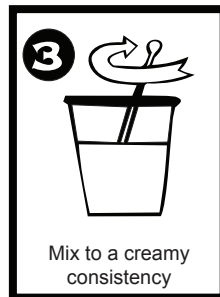
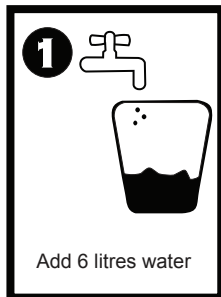

Is a polymer modified cement based tile adhesive designed specifically for large format ceramic tiles (>400 mm x 400 mm) & tiles with high porosity (>8%). Due to the improved flexibility of this product, **PROGRIP FLEXIGRIP** is suitable for high stress areas (suspended slabs), interior & exterior applications and intermittently wet conditions.

MIXING INSTRUCTIONS:

1. Add 6 litres of water to suitable container.
2. Slowly add 25 kg of tile adhesive.
3. Mixing with an electric drill and paddle will ensure thorough mixing.
4. Mix to a creamy consistency
5. Use within 3 hours.

SURFACE PREPARATION:

(In accordance with the KEBS standard KS 2130:2008 and SABS specifications SANS 10107:2001 code practice for installation of ceramic tiles)

1. Ensure that surfaces to be tiled are clean and free of dust, release agent, fungi, or any surface dampness. Fungi must be removed and the spores killed with the effective use of a fungicide. (A dilution of ordinary household bleach is suitable).
2. New walls and floors must be allowed to cure for minimum periods as tabled below to ensure that movement due to shrinkage does not affect the tiling.
 - a. Direct bedding onto new brick walls and concrete surfaces at least 6 weeks.
 - b. New plaster at least 2 weeks.
 - c. New screeds at least 4 weeks
3. For tiling onto very smooth surfaces such as steel trowelled, and off-shutter concrete: the surface must be acid washed to remove the laitance, and then rinsed thoroughly with cold water. The surface must then be primed with a mixture consisting of 2 parts **PRO GRIP Basecoat** with 1 part **PRO GRIP Keycoat** and allowed to dry prior to tiling.
4. Painted surfaces, gypsum plasters and surfaces that have old bitumen adhesive on them must be chipped in order to expose at least 80% of the substrate. The surface must then be primed with a mixture consisting of 2 parts **PRO GRIP Basecoat** mixed with 1 part **PRO GRIP Keycoat** and allowed to dry prior to tiling.
5. Highly porous substrates can negatively affect the bond strength of the tile adhesive. Check the porosity of the substrate by applying a small quantity of water. If the moisture is completely absorbed within one minute then the surface is too porous and will need to be sealed with a mixture of 2 parts **PRO GRIP Basecoat** and 1 part **PRO GRIP Keycoat** and allowed to dry prior to tiling.

APPLICATION

Only apply sufficient adhesive to an area that can be tiled within 10 minutes. Use a suitable notched trowel to maintain a minimum bed height of 6-7 mm for the floor tiling and 3-4 mm for wall tiling. The recommended trowels are as follows.

Application	Trowel size (height x width x gap)
Wall tiles	6 mm x 8 mm x 5 mm
Floor tiles smaller than 400 mm x 400mm	10 mm x 10 mm x 6 mm
Floor tiles larger than 400 mm x 400mm	17 mm x 22 mm x 6 mm

GENERAL APPLICATION INFORMATION

- a. DO NOT BUTT JOINT TILES.
- b. Minimum grouting joint width for wall tiling is 2 mm and to floors 3mm unless otherwise specified by the tile manufacturer.
- c. Bed tiles into wet adhesive with a twisting action in order to ensure adequate contact with the back of the tile. The use of a rubber mallet will be required when bedding heavy tiles.
- d. Remove all tile adhesive from the grouting joints as the application progresses.
- e. Tiles with very uneven backs will require buttering with adhesive prior to bedding into wet adhesive.
- f. For permanently wet conditions or where heavy duty strength is required, replace water in the mix with **PRO GRIP Bonding Liquid** in the ratio of 25kg **PRO GRIP Tile Adhesive** to 6 litres of **PRO GRIP Bonding Liquid**.
- g. It is very important to allow for differential movement in all tiling applications, so the inclusion of Tile Panel Movement joints, Structural Movement joints and Perimeter joints is essential.

GROUTING

- Allow at least 24 hours before grouting can commence.
- Ensure that all adhesive is removed from the joints.
- Grout with **PRO GRIP Waterproof Tile Grout** in various colours

TECHNICAL DATA

Non-hazardous	Non flammable, freeze and thaw resistant.
Initial setting time	±6 hours at 25°C and 50% humidity
Final setting time	±24 hours at 25°C and 50% humidity
Correction time	±25 minutes at 25°C and 50% humidity
Open time	±20 minutes at 25°C and 50% humidity
Pot life	±3 hours 25°C and 50% humidity
Temperature	Resistant up to 100°C
Storage	Store dry
Shelf life	9months in dry moderate conditions
Coverage per 25 kg	±2.8 m ² using a 22 mm notched trowel ±4.8 m ² using a 10mm notched trowel ±7.5 m ² using a 6mm notched trowel
Packaging	25kg

PRECAUTIONS

- a. Ensure that the above instructions are adhered to at all times and that the product is not adulterated in any way as this could cause failure.
- b. Rubber gloves should be used when applying **PRO GRIP FLEXIGRIP TILE ADHESIVE**. In the event of contamination, rinse skin under cold water. Consult a doctor should skin irritation persist.
- c. Keep **PRO GRIP FLEXIGRIP TILE ADHESIVE** away from pets and children.
- d. Do not ingest and do not empty contents down drains.

Manufactured by Ezeetile (k) Ltd
P.O. Box 84653-80100 Mombasa
www.ezeetile.co.ke



SM#19910